

Item No.: GET119E-L

Installation guide

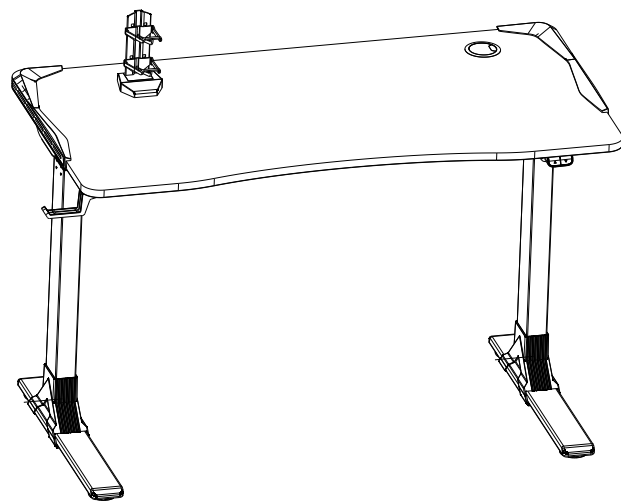

Technical Data

Item No.	GET119E-L
Column Design	2-stage & enhanced column
Maximum Load	50KG
Max Speed	25mm/s
Highest Position	1250mm
Lowest Position	750mm
Height range	500mm
Inner tube	70mmx40mm
Outer tube	75mmx45mm
Desktop	1200mmx600mmx18mm MDF

Accessory List

Attention: The drawings below are only for reference which might be slightly different from the actual object, please in kind prevail. Any tools missing or installation problems, please contact the customer service firstly.

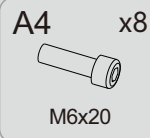
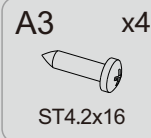
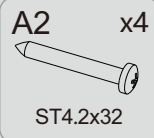
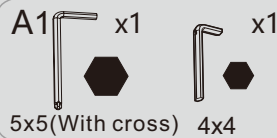

Part List

No.	Part	Qty	No.	Part	Qty
①	Tabletop set	1	②	Left lifting column set	2
③	Feet	2	④	Power plug	1
⑤	Cable Tie	4	⑥	Lifting column cover	2
⑦	Feet cover	2	⑧	Handle Rack	1
⑨	Headphone Hook	1	⑩	USB Cable Switch Rod	1
⑪	Handset	1	⑫	USB Cable	1
⑬	Remote Control	1	⑭	Handset Hook	2
⑮	Handset Support Rack	1			

Installation Instruction

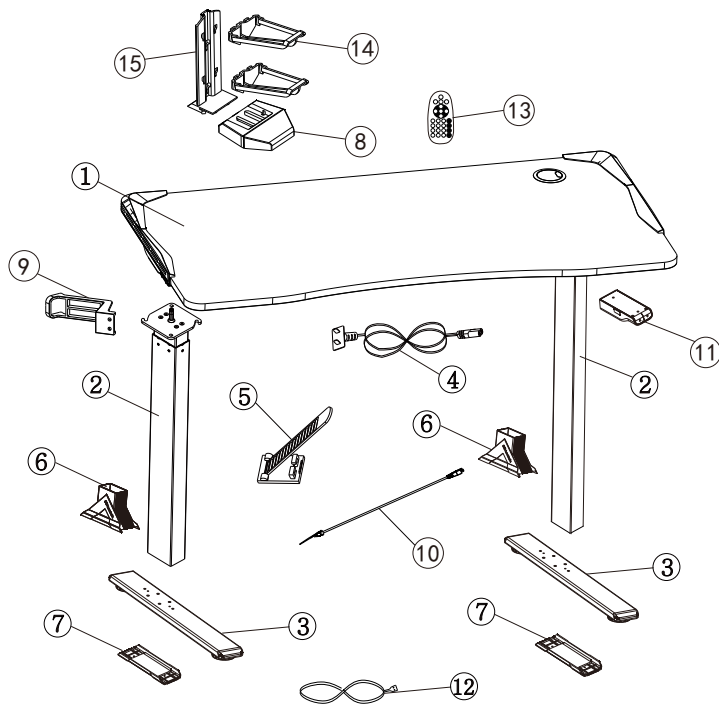

STEP1

Install the lifting column



Rotate the column after inserting it to the bottom to avoid height difference

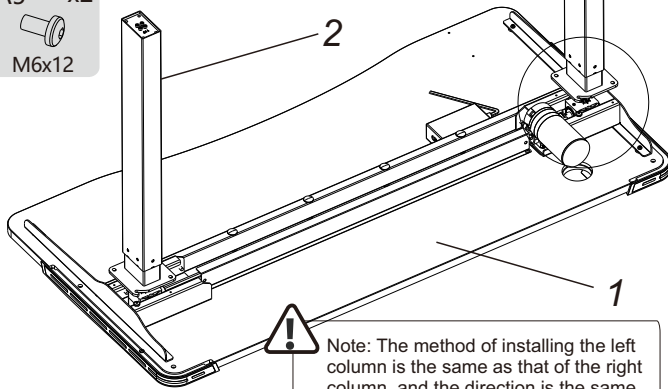

Note: The method of installing the left column is the same as that of the right column, and the direction is the same.

Install the left column 1

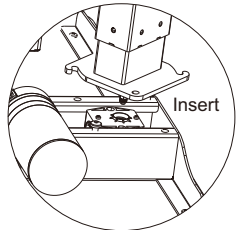

1.Insert the column coupling into the gear box as shown in the figure.

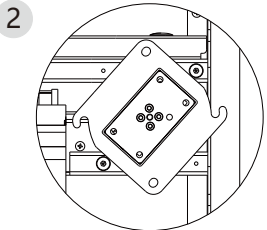

2.Rotate the left column to the position shown in the figure to avoid the screws, and rotate it counterclockwise after fully inserting it.

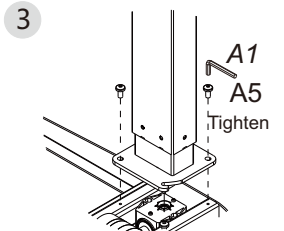

3. After rotating as shown in the figure, use a 4x4 allen key to tighten two M6x12 screws to complete the installation of the left column

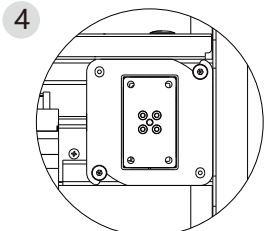

4. The installation of the other side column is the same as that of the left column, and the direction is the same.

STEP2

Install the feet

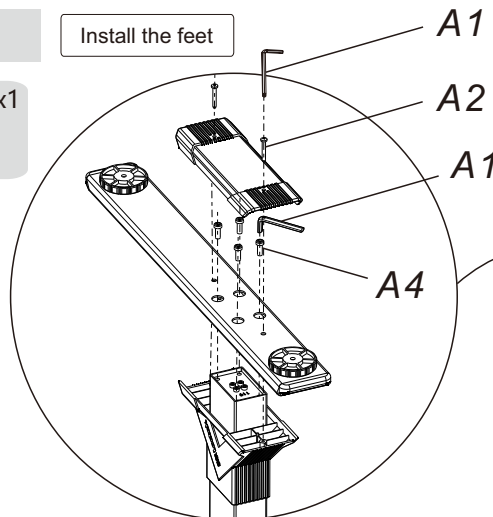

Connect the feet to the column, use a 4x4 allen key (A1) to screw eight M6x20 (A4) and tighten them, and use a 5x5 allen key (A1) to screw ST4.2x32 self-tapping screws (A2) to fix the lifting column cover (6) and the feet cover(7).

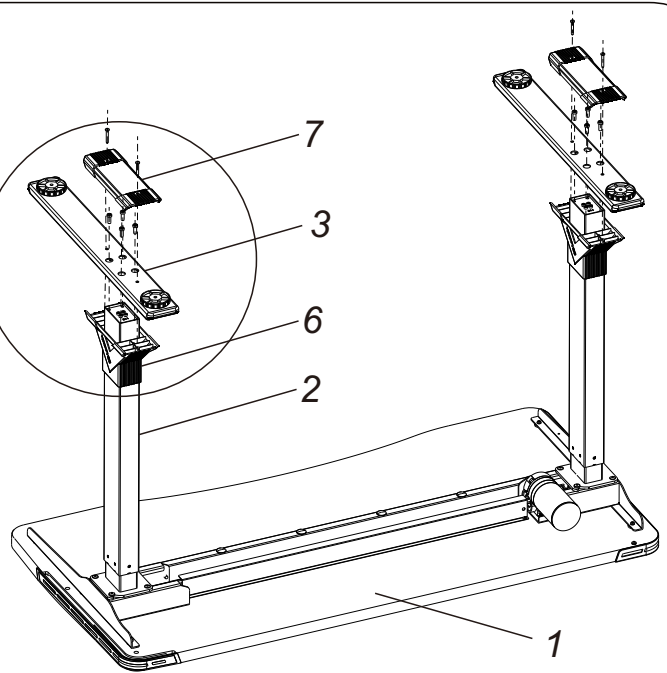

STEP3

Install the handset

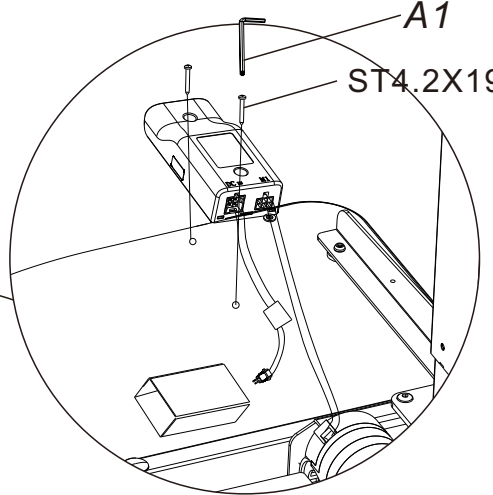
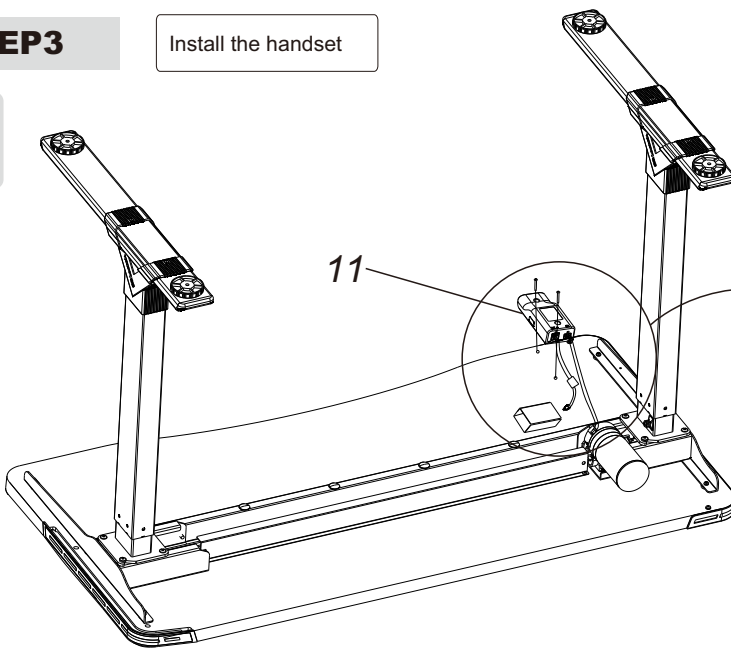

Put the handset into the position shown in the figure above, align the two bottom holes of the table as shown in the figure, and not align the other bottom holes. Use a 5x5 allen key with cross (A1) to fix it with two ST4.2x19 self-tapping screws.

STEP4

Install the Cables and Light Strip

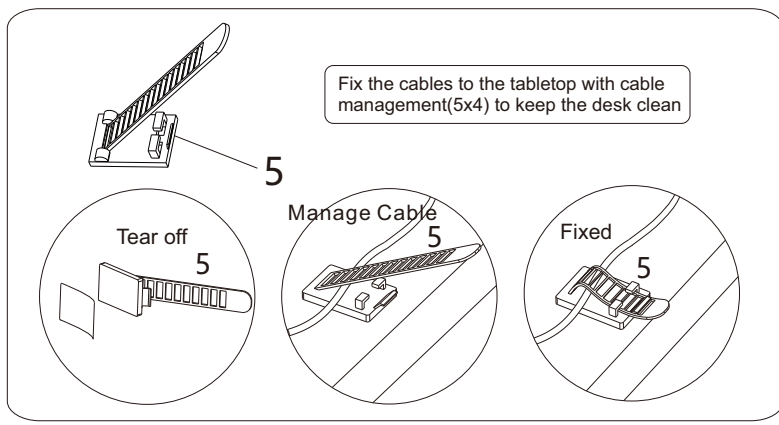
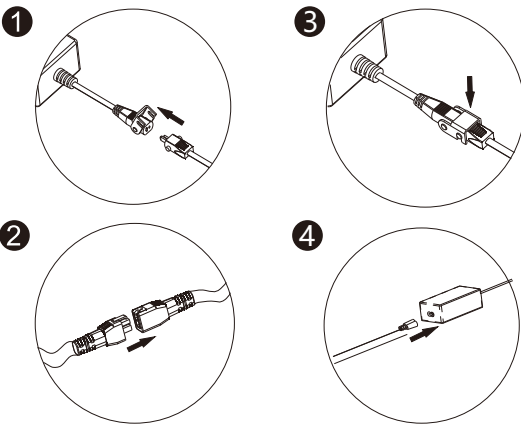
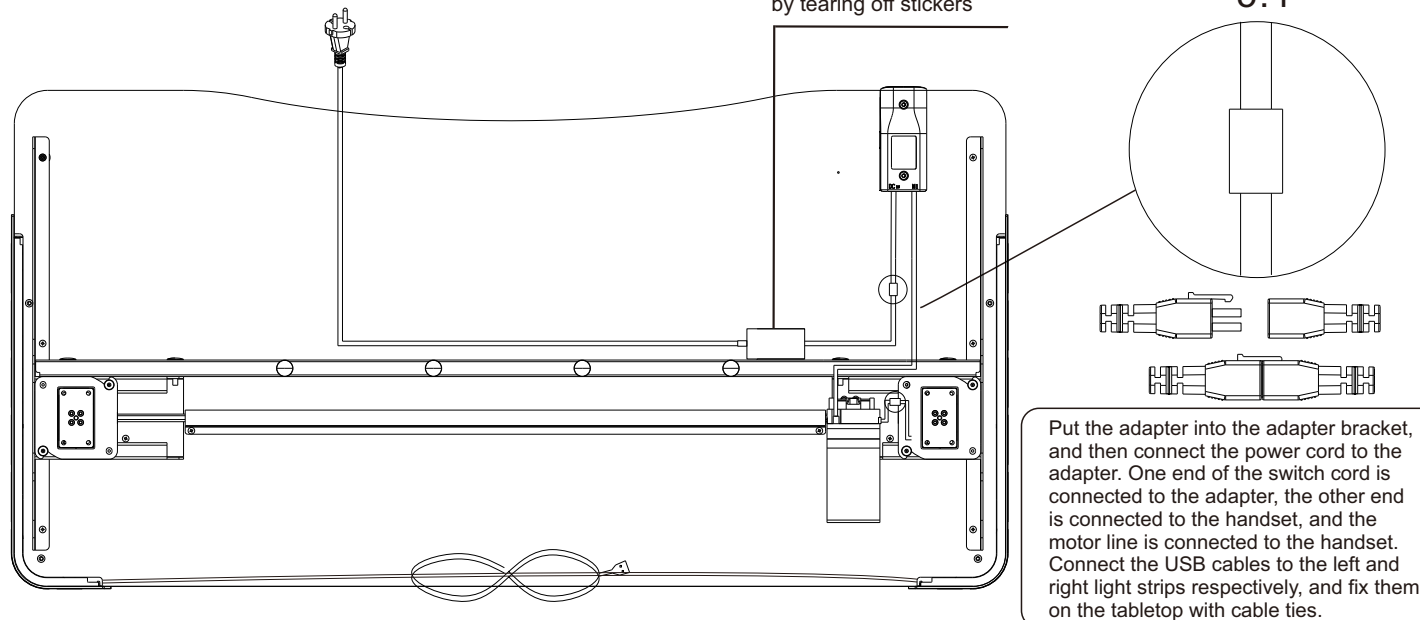

STEP5

Install Accessories

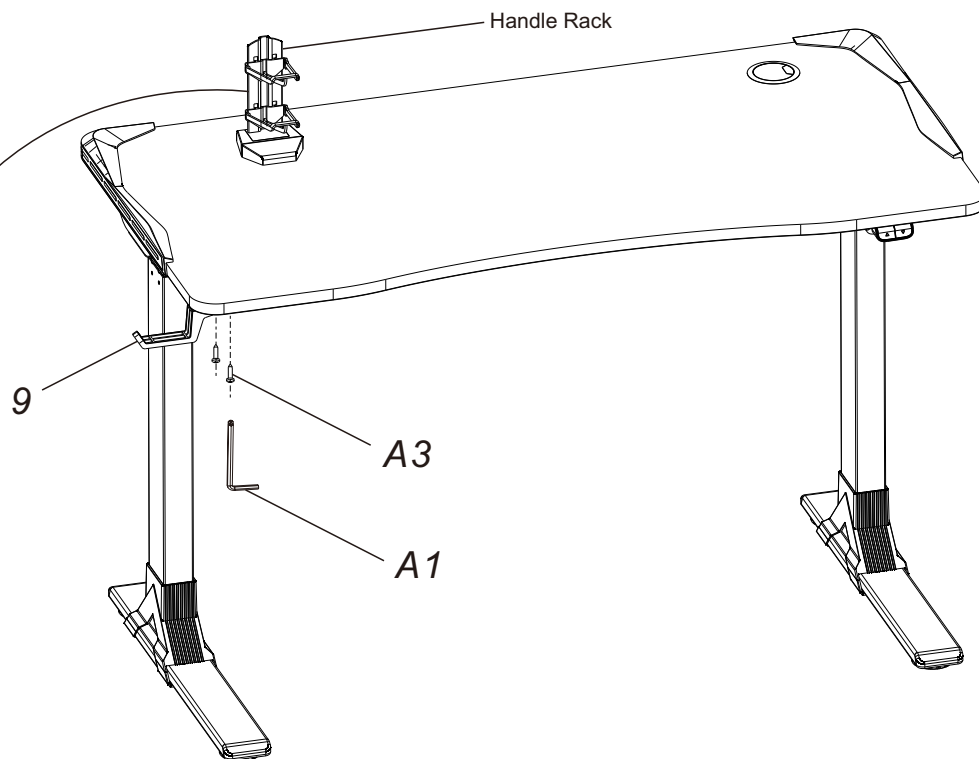
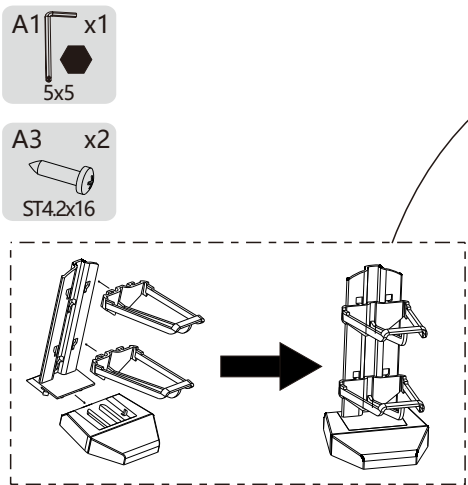

How to use handswitch

●	“▲”	Adjust the desk upwards
●	“▼”	Adjust the desk downwards

Instruction

- **Lifting Function**
press the “▲” or “▼” button to increase or decrease the height
- **Reset Function**
(1) Hold the “▼” button for more than 5 seconds to enter reset mode when at the lowest position. The reset is not completed until the lifting system reaches the bottom, then rebounds to stop.
(2) When the lifting system fails, release the button and long press the “▼” button. The reset is not completed until the lifting system reaches the bottom, then rebounds to stop.
- **Resistance Function**
(1) Built-in sensor, when encountering any objects, the device instantly stops and reverses to avoid damage.
(2) Simultaneously press the “▲” and “▼” button for more than 5 seconds to turn off or turn on the resistance function.

Common fault treatment

The following tips will help you detected and eliminate the common fault and error. If the fault you met is not listed below, please contact with your supplier. Only the manufacturer and professionals are capable for investigating and correcting those fault and error.

Fault phenomenon	Method
No response while long pressing down arrow after connected with a power supply	1. Check if all the cables be connected well 2. Contact your supplier or dealer
The desktop could not be lifted	1. Check if overloaded, max loading: 50kg 2. Contact your supplier or dealer
Overwork (Duty cycle: Max 2min on/30min OFF)	1. Restart it after suspend for 30mins for the working time is too long 2. Contact your supplier or dealer

Button

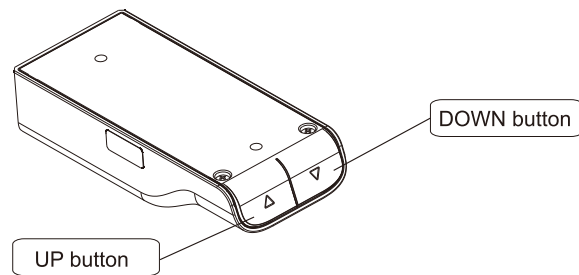

Waste disposal



This marking indicates that this product should not be disposed with other household wastes. To prevent possible harm to the environment or human health from uncontrolled waste disposal, recycle it responsibly to promote the sustainable reuse of material resources. To return your used device, please use the return and collection systems or contact the retailer where the product was purchased. They can take this product for environmental safe recycling.

Remote Control

16 Single Colors 8 Dynamic Modes

18m Long Distance Control

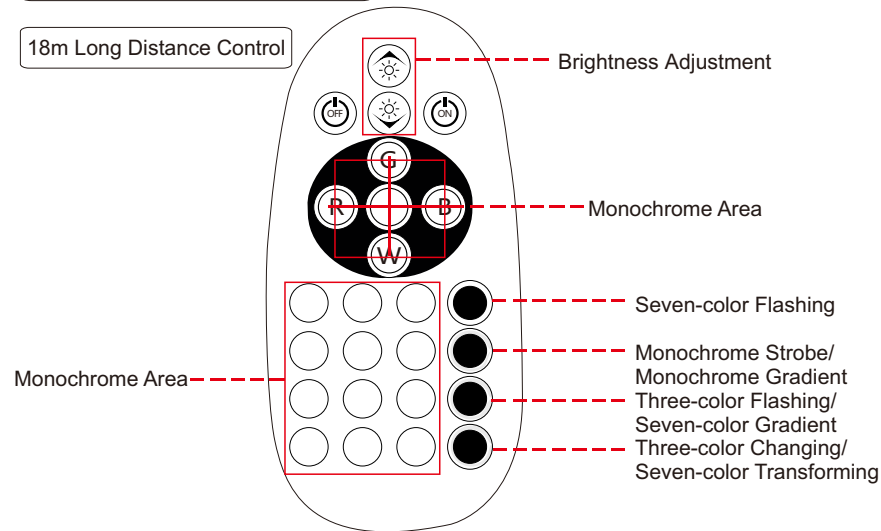

Attention

1. Power supply: AC100V-240V, 50/60HZ
2. Service Environment: 0-40℃
3. Unplug the power plug before cleaning, wipe the dust on surface with slight wet dishcloth when cleaning, be careful not to let the drops into the internal parts, not loose the connector.
4. The electric box contains electronic components, metals, plastics, wires etc., so dispose of it in accordance with each country's environmental legislation, not the general household waste.
5. Check carefully to ensure correct and complete assembly before using.
6. Be familiar with all functions and program settings of the product before first use.
7. Children are forbidden to play on the product because of unforeseen action when playing, so any dangerous consequences caused by this improper action will not be on
8. Slight noise caused by the V-ribbed belt or brake system due to structure will not have any effect on the use of the equipment.
9. Corrosive or abrasive materials are forbidden to clean the equipment. Must ensure that the cleaner used will not pollute the environment.
10. Please make sure there is no hazard sources in your operating environment, e.g., do not litter the tools around. Always be careful to treat the packaging materials in order to avoid any possible danger, e.g. plastic bag may lead to choking hazard to children.
11. Keep the original package of the equipment if necessary in case of the future use in transportation.
12. The following tips will help you detected and eliminate the common fault and error. If the fault you met is not listed below, please contact with your supplier. Only the manufacturer and professionals are capable for investigating and correcting those fault and error.